

LEGEND

- City Limits Line
- City ETJ
- Drainage Channel
- Pipelines

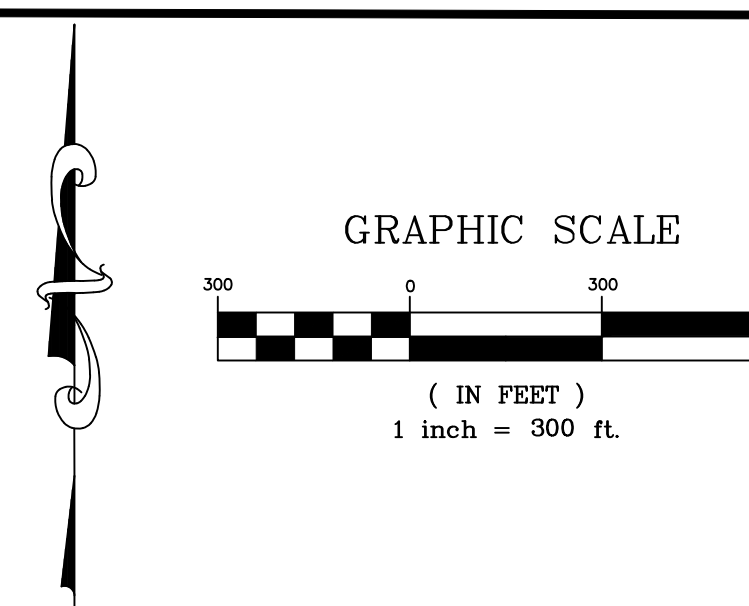

ZONING DESIGNATIONS

- M-1 - Light Manufacturing District
- M-2 - Medium Manufacturing District
- M-3 - Mixed Manufacturing District
- B-2 - Secondary and Highway Business District
- R-1 - One-Family Dwelling District (9,001 SF to 14,000 SF)
- R-2 - Multi-Family Dwelling District (< 5,000 SF)
- R-3 - One-Family Dwelling District (> 20,000 SF)
- R-4 - One-Family Dwelling District (5,000 SF to 9,000 SF)
- R-5 - One-Family Dwelling District (14,001 SF to 20,000 SF)
- NED - Neighborhood Entryway District
- GOV - Government
- PD-1 - Plaza District
- B-1 - Neighborhood Business District
- RC-1 Robinson Commercial District

SPECIFIC USE PERMITS

- Elder's Automotive 27431 Hanna Rd
Auto Repair - Variance 03/26/2013
Light Manufacturing - Ord. No. 13-2013, 03/11/2013
- Oak Ridge Reformed Baptist Church and School
27420 Robinson Rd
Ord. No. 19-2014, 03/24/2014
- Flips-N-Fun, Inc. 27320 Robinson Rd
Ord. No. 20-2014, 03/24/2014
- Printing Plus, 27421 Robinson Rd
Ord. No. 32-2014, 06/9/2014
- Robinson Road Center, Suites 201-225 27326 Robinson
Ord. No. 58-2014, 10/13/2014
- Facility Concession Services, Inc. 27433 Robinson Rd
Ord. No. 65-2014, 12/15/2014
- Thomas Coale 26789 Hanna Rd
Ord. No. 12-2015, 5/27/2015
- Woodland Medical Properties, 26710 I-45 North, Bldgs. B,C
Ord. No. 41-2015, 11/9/2015
- Troy Parks, 26797 Hanna Rd
Ord. No. 08-2016, 1/11/2016
- Scipio, L.P., 26722-26734 Robinson Rd, Suite 3
Ord. No. 09-2016, 2/8/2016
- Chinary Salon Tanning & Day Spa, LLC 27327
Robinson Rd, Ste 3
Ord. No. 35-2016, 12/12/2016
- The Office of the Messianic Rabbi of Congregation Battzion
26803 Hanna Rd., Bldg. 5, Suite 9 & 10
Ord. No. 16-2016, 4/11/2016
- T&L Combs, Inc., 27734 I-45 North
Ord. No. 19-2016, 5/9/2016
- A&M Interest, Inc., 26541 I-45 North
Ord. No. 20-2016, 5/9/2016
- DCP Southern Hills Pipeline, LLC, (not shown on map)
Ord. No. 2012-14, 7/23/2012

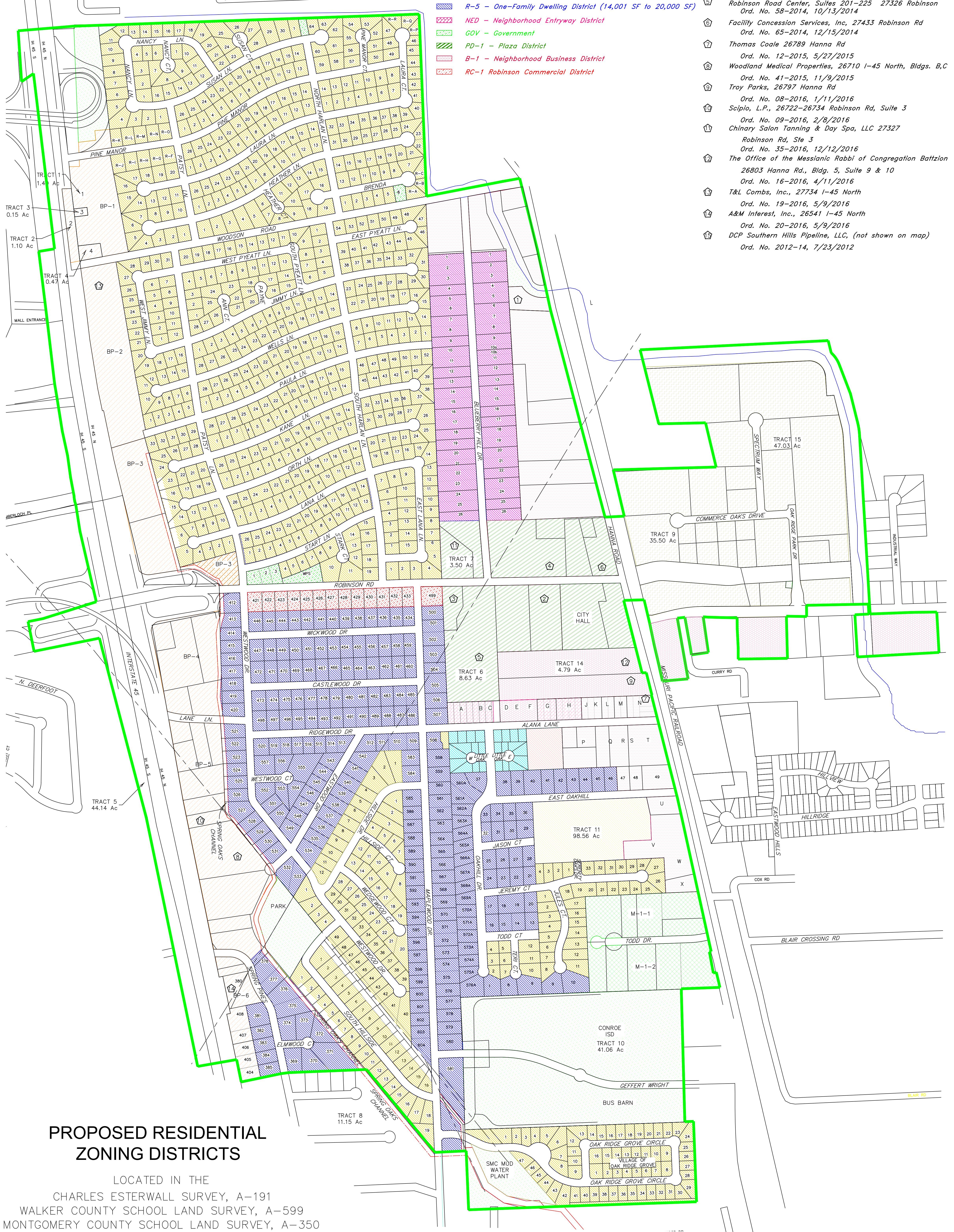

PROPOSED RESIDENTIAL ZONING DISTRICTS

LOCATED IN THE
 CHARLES ESTERWALL SURVEY, A-191
 WALKER COUNTY SCHOOL LAND SURVEY, A-599
 MONTGOMERY COUNTY SCHOOL LAND SURVEY, A-350
 MONTGOMERY COUNTY, TEXAS
 DECEMBER 2017